

**PROPERTY DESCRIPTION:**

LOCATED GENERALLY NORTH AND WEST OF THE INTERSECTION OF EAST FRONT STREET AND US HIGHWAY 435, KANSAS CITY, MISSOURI. THIS PROPERTY HAS 320 FEET OF FRONTAGE ON FRONT STREET. CONTAINS 73,524 SQUARE FEET, OR 1.6879 ACRES, MORE OR LESS.

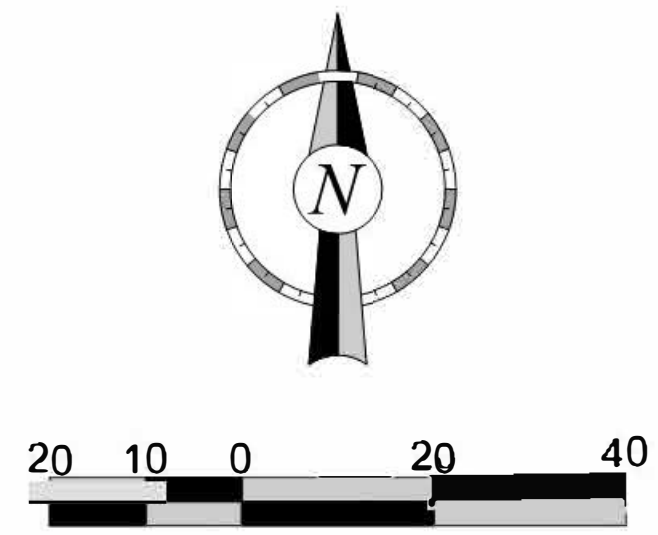
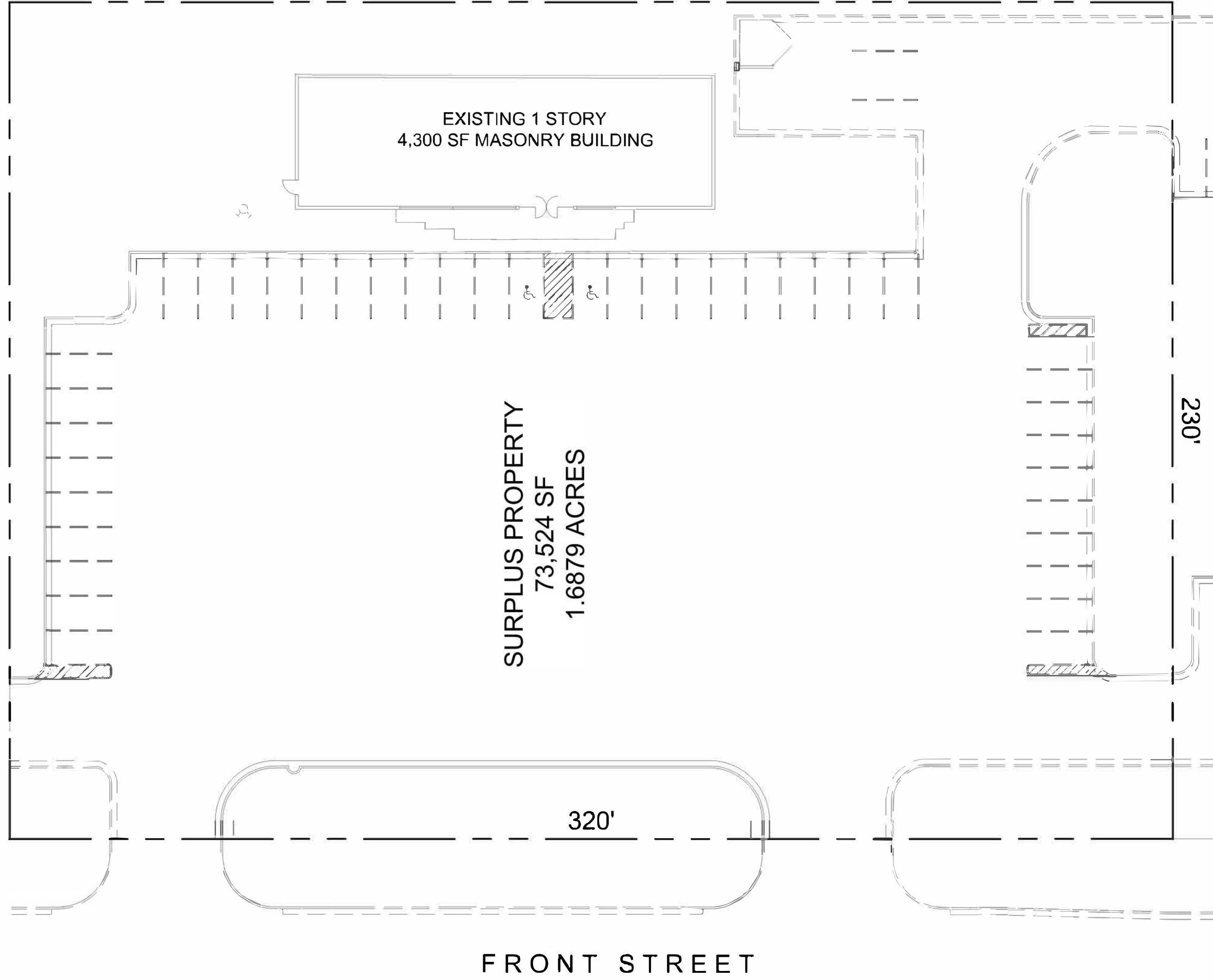

<b>PROJECT NO.:</b>	
<b>QuikTrip No. E224-1</b>	6820 EAST FRONT STREET KANSAS CITY, MO
<b>QT</b>	© COPYRIGHT QUIKTRIP CORPORATION 2011 ANY UNAUTHORIZED USE, REPRODUCTION, PUBLICATION, DISTRIBUTION, OR SALE IN WHOLE OR IN PART IS STRICTLY FORBIDDEN.
<b>PROTOTYPE: P-71 (05/01/12)</b>	
<b>DIVISION:</b>	
<b>VERSION: #01</b>	
<b>DESIGNED BY:</b>	
<b>DRAWN BY:</b>	
<b>REVIEWED BY:</b>	
<b>REV   DATE   DESCRIPTION</b>	<b>ORIGINAL ISSUE DATE:</b>
<b>SHEET TITLE:</b>	
SURPLUS PROPERTY	
<b>SHEET NUMBER:</b>	
1	