

PROPERTY DESCRIPTION:
 LOCATED GENERALLY SOUTH AND WEST OF THE INTERSECTION OF BUFORD DRIVE AND BRANDSMART WAY, BUFORD, GEORGIA. THIS PROPERTY HAS 90 FEET OF FRONTAGE ON BUFORD AND 240 FEET OF FRONTAGE ON LAUREL DRIVE. CONTAINS 88,866 SQUARE FEET, OR 2.0401 ACRES, MORE OR LESS.

SURPLUS PROPERTY
 88,866 SF
 2.0401 ACRES

NOT FOR SALE

NOT FOR SALE

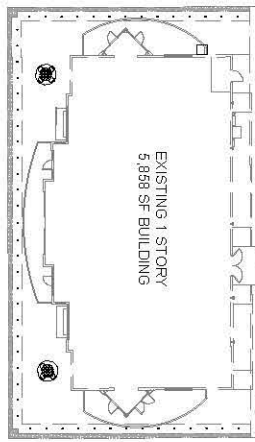

Georgia Highway No. 20 (Buford Drive)

Brandsmart Way
 (Asphalt Pavement)

Laurel Drive
 Gravel Drive

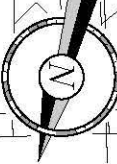

REV	DATE	DESCRIPTION

ORIGINAL ISSUE DATE: 07-20-15

PROTOTITLE:
 DIVISION: 07
 VERSION: 001
 DESIGNED BY:
 DRAWN BY:
 REVIEWED BY:



QuikTrip No. 4785-1
 2900 BRUFORD DRIVE
 BUFORD, GA

PROJECT NO.:

SHEET TITLE:
 SURPLUS PROPERTY
 SHEET NUMBER:
1